

PVC PRESSURE SYSTEMS

PT REINFORCED TEE (Metric)

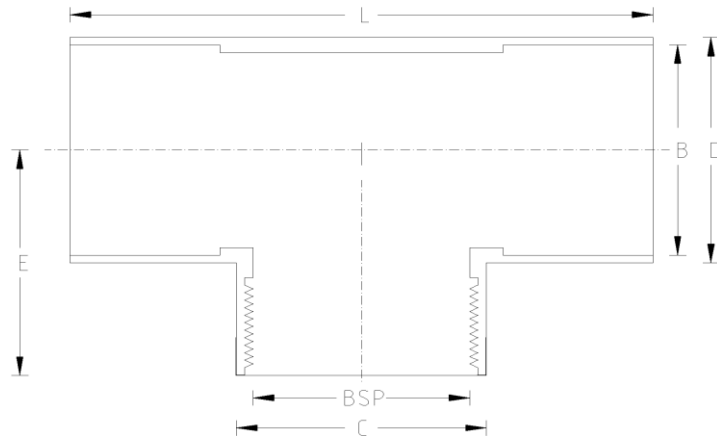

DATA TABLE

SIZE	B (mm)	BSP (mm)	C (mm)	D (mm)	E (mm)	L (mm)	WEIGHT (g)
20mm : 1/2"	20.0	21.0	30.0	30.0	28.0	56.0	18.0
25mm : 3/4"	25.0	26.4	37.0	37.0	33.0	66.0	25.0
32mm : 1"	32.0	33.2	45.0	45.0	38.0	76.0	38.0
40mm : 1 1/4"	40.0	41.9	53.0	53.0	45.0	90.0	60.0
50mm : 1 1/2"	50.0	47.8	65.0	64.0	50.0	100.0	95.0
63mm : 2"	63.0	59.6	76.0	77.0	70.0	144.0	165.0

SPECS

- WRAS Approved
- Maximum Working Pressure - 10bar
- Operation Temperature 0 - 60°C

Temperature Derating Table

Temperature C	Pressure rating bar
20	10.0
30	8.0
40	5.8
50	3.9
60	2.2

RELATED PRODUCTS

- 51125 - 125ml UNI100 Griffon Cement w.brush
- 51023 - 500ml UNI100 Griffon Cement w. brush
- 51025 - 500ml UNI100 Griffon Cement - Tin
- 51012 - 500ml Tangit Cement - Tin
- 51024 - 500ml WDF-05 Blue Fast Setting Cement
- 51021 - 500ml PVC Cleaner
- 2817 - 50mm roll Emery Cloth
- 40911 - Centre Pull Paper Towel

Plastic Pipe Shop Ltd

Unit 1, Craig Leith Road
Broadleys Business Park,
Stirling, FK7 7XQ
Web: www.plasticpipeshop.co.uk
Email: sales@plasticpipeshop.co.uk
Tel: 01786 472 850

Plastic Pipe Shop Ltd

Drawing Name	Metric PT Reinforced Tee
Drawing No.	METPTREINTEE/PPF100
Drawn by	BB
Last revision	30 March 2023
Sheet	1/1
Manufacturer	PLIMAT