

## PT 90 ELBOW (Metric)

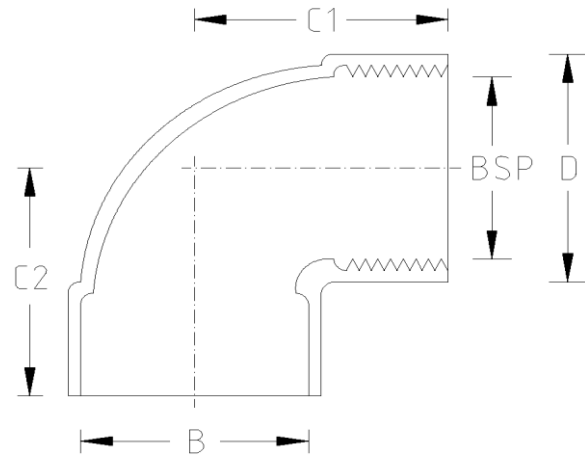

### DATA TABLE

SIZE	B (mm)	BSP (mm)	C1 (mm)	C2 (mm)	D (mm)	WEIGHT (g)
20mm - 1/2"	20.0	21.0	28.5	28.5	28.6	27.0
25mm - 3/4"	25.0	26.4	33.0	33.0	35.1	43.0
32mm - 1"	32.0	33.2	40.5	40.5	44.3	78.0
40mm - 1 1/4"	40.0	41.9	46.5	46.5	52.4	109.0
50mm - 1 1/2"	50.0	47.8	52.0	52.0	61.0	158.0
63mm - 2"	63.0	59.6	63.0	63.0	75.9	282.0
75mm - 2 1/2"	75.0	75.2	82.0	82.0	87.5	335.0
90mm - 3"	90.0	87.9	97.0	97.0	104.2	620.0
110mm - 4"	110.0	113.0	131.3	131.3	132.1	1055.0

### SPECS

- WRAS Approved
- Maximum Working Pressure - 10bar
- Operation Temperature 0 - 60°C

### Temperature Derating Table

Temperature C	Pressure rating bar
20	10.0
30	8.0
40	5.8
50	3.9
60	2.2

### RELATED PRODUCTS

- 51125 - 125ml UNI100 Griffon Cement w.brush
- 51023 - 500ml UNI100 Griffon Cement w. brush
- 51025 - 500ml UNI100 Griffon Cement - Tin
- 51012 - 500ml Tangit Cement - Tin
- 51024 - 500ml WDF-05 Blue Fast Setting Cement
- 51021 - 500ml PVC Cleaner
- 2817 - 50mm roll Emery Cloth
- 40911 - Centre Pull Paper Towel

## Plastic Pipe Shop Ltd

Unit 1, Craig Leith Road  
Broadleys Business Park,  
Stirling, FK7 7XQ  
Web: [www.plasticpipeshop.co.uk](http://www.plasticpipeshop.co.uk)  
Email: [sales@plasticpipeshop.co.uk](mailto:sales@plasticpipeshop.co.uk)  
Tel: 01786 472 850

## Plastic Pipe Shop Ltd

Drawing Name	Metric PT 90 Elbow
Drawing No.	METPTELB/PPF98
Drawn by	BB
Last revision	25 October 2023
Sheet	1/1
Manufacturer	ERA/PLIMAT/EFFAST