

GALVANISED BACKING RING PN10/16

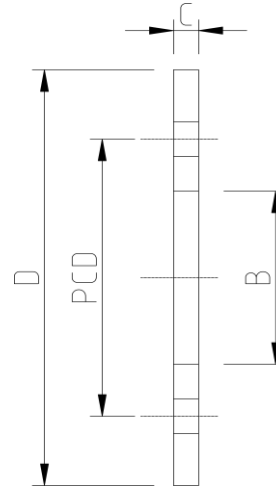

DATA TABLE

SIZE	B (mm)	C (mm)	D (mm)	Holes	PCD - NP10 (mm)	WEIGHT (g)
1/2"	27.0	6.0	95.0	4	65.0	350
3/4"	34.0	6.0	105.0	4	75.0	410
1"	42.0	6.0	115.0	4	85.0	490
1 1/4"	52.0	6.0	140.0	4	100.0	730
1 1/2"	61.0	6.0	150.0	4	110.0	820
2"	79.0	8.0	165.0	4	125.0	1221
2 1/2"	91.0	8.0	185.0	4	146.0	1480
3"	111.0	8.0	200.0	8	160.0	1500
4"	139.0	8.0	220.0	8	180.0	1680
6"	198.0	10.0	285.0	8	240.0	2700
8"	241.0	10.0	250.0	12	295.0 NP16	3230

SPECS

- WRAS Approved
- Galvanised Mild Steel

RELATED PRODUCTS

- [- Full Face Flange](#)
- [- Bolt Sets](#)

Plastic Pipe Shop Ltd

Unit 1, Craig Leith Road,
Broadleys Business Park,
Stirling, FK7 7LQ

Web: www.plasticpipeshop.co.uk
Email: sales@plasticpipeshop.co.uk
Tel: 01786 472 850

Plastic Pipe Shop Ltd

Drawing Name	Imperial Galv Backing Ring PN10
Drawing No.	IMPGBRPN1016/PPF23
Drawn by	BB
Last revision	18 August 2020
Sheet	1/1
Manufacturer	ERA