

BSP PT ADAPTOR (Imperial)

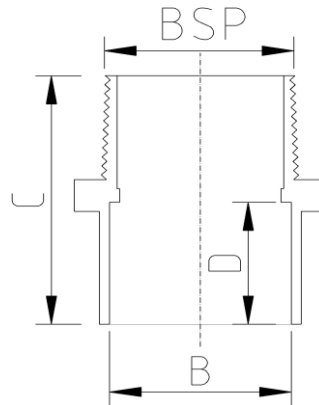

DATA TABLE

SIZE	B (mm)	C (mm)	D (mm)	BSP	WEIGHT (g)
1/2"	21.3	41.5	17.0	1/2"	11.5
3/4"	26.7	46.5	20.0	3/4"	17.5
1"	33.4	55.0	23.0	1"	31
1 1/4"	42.2	58.5	27.5	1 1/4"	49
1 1/2"	48.3	63.0	30.5	1 1/2"	65.5
2"	60.3	75.0	36.5	2"	91.5
2 1/2"	75.2	99.0	44.0	2 1/2"	200
3"	88.9	113.0	52.0	3"	300
4"	114.3	120.0	63.0	4"	500

SPECS

- WRAS Approved
- Maximum Working Pressure - 10bar
- Operation Temperature 0 - 60°C

Temperature Derating Table

Temperature C	Pressure rating bar
20	10.0
30	8.0
40	5.8
50	3.9
60	2.2

RELATED PRODUCTS

- [51023 - 500ml Griffon Uni-100 PVC Cement](#)
- [51010 - 500ml Tangit Cement](#)
- [51024 - 500ml Griffon WDF-05 Fast Setting PVC Cement](#)
- [51021 - 500ml Griffon Pipe Cleaner](#)
- [2817 - 50mm roll Emery Cloth](#)
- [40911 - Centre Pull Paper Towel](#)
- [13293 - PTFE Tape](#)

Plastic Pipe Shop Ltd

Unit 1, Craig Leith Road
Broadleys Business Park,
Stirling, FK7 7XQ
Web: www.plasticpipeshop.co.uk
Email: sales@plasticpipeshop.co.uk
Tel: 01786 472 850

Plastic Pipe Shop Ltd

Drawing Name	Imperial BSP PT Adaptor
Drawing No.	IMPBSPTADAP/ERC33
Drawn by	BB
Last revision	22 August 2019
Sheet	1/1
Manufacturer	ERA/EFFAST