

90° TEE (Imperial)

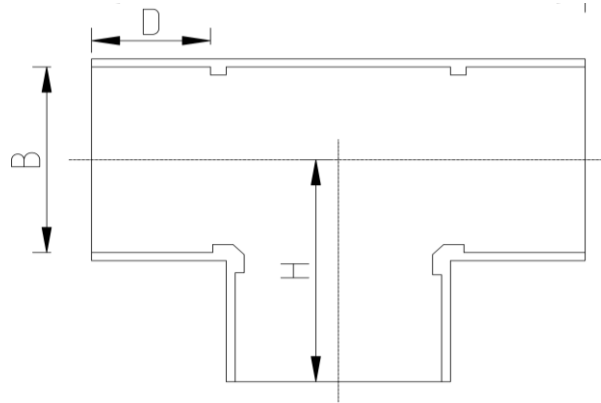

DATA TABLE

SIZE	B (mm)	D (mm)	H (mm)	Weight (g)
3/8"	17.1	15.0	24.0	15
1/2"	21.4	17.0	59.0	30
3/4"	26.7	20.0	71.0	48
1"	33.6	23.0	84.0	72
1 1/4"	42.2	27.5	103.0	125
1 1/2"	48.3	30.5	117.0	204
2"	60.3	36.5	143.0	365
2 1/2"	75.2	44.0	82.0	450
3"	88.9	51.0	202.7	915
4"	114.3	63.5	255.0	1682
6"	168.3	91.0	367.0	4876
8"	219.1	119.0	233.0	6703

SPECS

- WRAS Approved
- Maximum Working Pressure 15bar
- Operating Temperature 0 - 60°
- Comply with Sch40

RELATED PRODUCTS

- [51023 - 500ml Griffon Uni-100 PVC Cement](#)
- [51010 - 500ml Tangit Cement](#)
- [51024 - 500ml Griffon WDF-05 Fast Setting PVC Cement](#)
- [51021 - 500ml Griffon Pipe Cleaner](#)
- [2817 - 50mm roll Emery Cloth](#)
- [40911 - Centre Pull Paper Towel](#)

Temperature Derating Table

Temperature C	Pressure rating bar
20	15.0
30	12.0
40	8.7
50	5.9
60	3.3

Plastic Pipe Shop Ltd

Unit 1, Craig Leith Road,
Broadleys Business Park,
Stirling, FK7 7LQ
Web: www.plasticpipeshop.co.uk
Email: sales@plasticpipeshop.co.uk
Tel: 01786 472 850

Plastic Pipe Shop Ltd

Drawing Name	Imperial 90 Tee PVC
Drawing No.	IMP90TEE/PPF06/ERC06
Drawn by	BB
Last revision	21 January 2020
Sheet	1/1
Manufacturer	ERA