

## 90° ELBOW (Imperial)

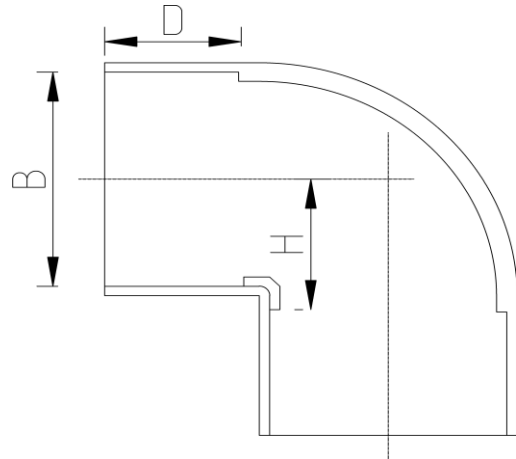

### DATA TABLE

SIZE	B (mm)	D (mm)	H (mm)	Weight(g)
1 1/2"	48.3	34.0	28.0	135
2"	60.3	40.0	34.0	220

### SPECS

- WRAS Approved
- Maximum Working Pressure - 10bar
- Operating Temperature 0 - 60°C

### RELATED PRODUCTS

- [51023 - 500ml Griffon Uni-100 PVC Cement](#)
- [51010 - 500ml Tangit Cement](#)
- [51024 - 500ml Griffon WDF-05 Fast Setting PVC Cement](#)
- [51021 - 500ml Griffon Pipe Cleaner](#)
- [2817 - 50mm roll Emery Cloth](#)
- [40911 - Centre Pull Paper Towel](#)

### Temperature Derating Table

Temperature C	Pressure rating bar
20	10.0
30	8.0
40	5.8
50	3.9
60	2.2

## Plastic Pipe Shop Ltd

Unit 10, 9 Munro Road,  
Stirling, FK7 7XQ  
Web: [www.plasticpipeshop.co.uk](http://www.plasticpipeshop.co.uk)  
Email: [sales@plasticpipeshop.co.uk](mailto:sales@plasticpipeshop.co.uk)  
Tel: 01786 472 850

## Plastic Pipe Shop Ltd

Drawing Name	Imperial 90 Elbow PVC
Drawing No.	IMPWH90ELB/PPF150
Drawn by	BB
Last revision	27 March 2019
Sheet	1/1
Manufacturer	ERA