

45° ELBOW (Metric)

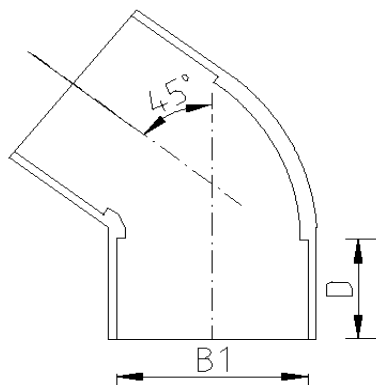

DATA TABLE

| SIZE | B1 (mm) | D (mm) | Weight (g) |
|-------|---------|--------|------------|
| 12mm | 12.0 | 12.0 | 10 |
| 16mm | 16.0 | 14.0 | 17 |
| 20mm | 20.0 | 17.0 | 17 |
| 25mm | 25.0 | 19.5 | 30 |
| 32mm | 32.0 | 23.0 | 47 |
| 40mm | 40.0 | 28.5 | 77 |
| 50mm | 50.0 | 33.5 | 115 |
| 63mm | 63.0 | 40.0 | 190 |
| 75mm | 75.0 | 44.0 | 310 |
| 90mm | 90.0 | 51.0 | 485 |
| 110mm | 110.0 | 61.0 | 835 |
| 125mm | 125.0 | 69.0 | 1008 |
| 140mm | 140.0 | 76.5 | 1064 |
| 160mm | 160.0 | 86.5 | 2100 |
| 200mm | 200.0 | 107.0 | 5000 |
| 225mm | 225.0 | 106.0 | 6200 |
| 250mm | 250.0 | 119.0 | 8000 |
| 315mm | 315.0 | 165.0 | 10000 |

SPECS

- WRAS Approved
- Maximum Working Pressure - 10bar
- Operation Temperature 0 - 60°C

Temperature Derating Table

| Temperature C | Pressure rating bar |
|---------------|---------------------|
| 20 | 10.0 |
| 30 | 8.0 |
| 40 | 5.8 |
| 50 | 3.9 |
| 60 | 2.2 |

RELATED PRODUCTS

- [51023 - 500ml Griffon Uni-100 PVC Cement](#)
- [51010 - 500ml Tangit Cement](#)
- [51024 - 500ml Griffon WDF-05 Fast Setting PVC Cement](#)
- [51021 - 500ml Griffon Pipe Cleaner](#)
- [2817 - 50mm roll Emery Cloth](#)
- [40911 - Centre Pull Paper Towel](#)

Plastic Pipe Shop Ltd

Unit 1, Craig Leith Road,
Broadleys Business Park,
Stirling, FK7 7LQ
Web: www.plasticpipeshop.co.uk
Email: sales@plasticpipeshop.co.uk
Tel: 01786 472 850

Plastic Pipe Shop Ltd

| | |
|---------------|----------------------|
| Drawing Name | Metric 45 Elbow |
| Drawing No. | MET45ELB/PPF81/ERC81 |
| Drawn by | BB |
| Last revision | 20 August 2019 |
| Sheet | 1/1 |
| Manufacturer | ERA/PLIMAT |